

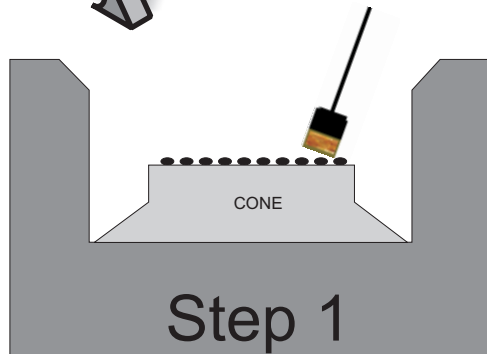

UGT Installation Instructions

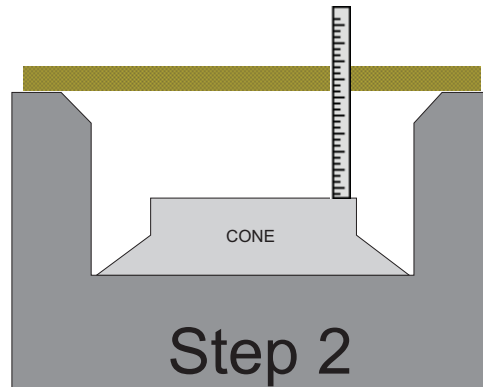

Clean top of cone section of all debris. Fix all surface defects with mortar.



Measure from base of cone to the desired height of top of the manhole frame.

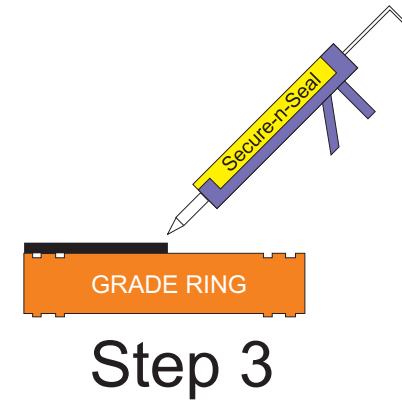

Apply beads of UGT Ring Secure-n-Seal on the bottom surface of grade ring. The bead placement should be put on the inside and outside perimeter of the ring as well as the flat landing areas.

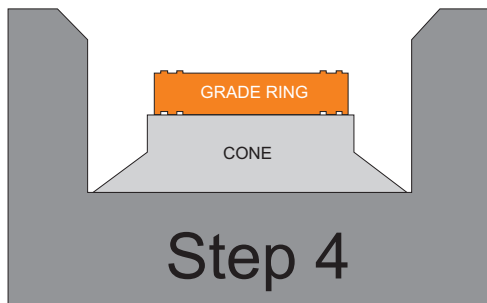

Place Grade Ring on top of the cone, bottom side down, centering the ID of Ring to ID of cone. Step on or press ring down to compress the Secure-n-Seal.

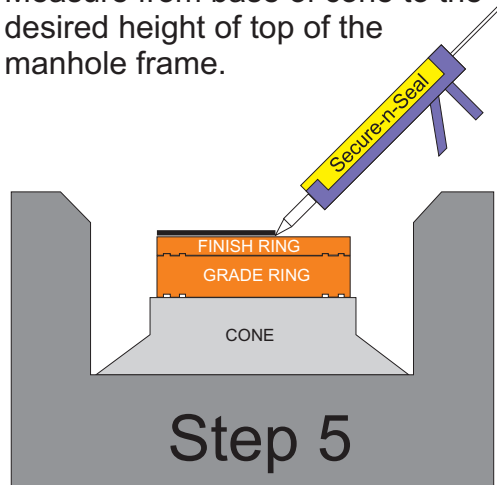

Install Finish Ring on top of Grade Ring (Female Groove Down) and apply UGT Secure-n-Seal to top surface of Finish Ring. Be generous with Secure-n-Seal to aid in creating a seal between Frame and Finish Ring.

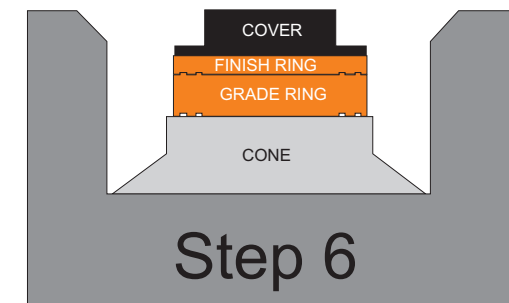

Install Manhole Frame on top of Finish Ring surface, centering frame to the ring section. Backfill and/or resurface as required.

